

ECLISPE CHROME WIRE QUICK FIT SHELVING

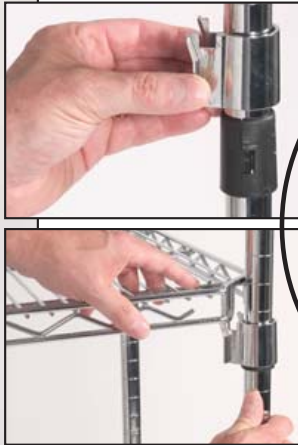

The unit is finished in hard wearing polished nickel chrome.



**FOR USE
THROUGHOUT
ALL INDUSTRIES,
INCLUDING CATERING
& FOOD SERVICES,
HOSPITAL & MEDICAL
STORES, ELECTRONICS
FACTORIES, OFFICES
& RETAIL
OUTLETS**

- **Add extra shelves in seconds**
- **No need to remove shelves above**
- **Quick and easy to clean**
- **Save on time and effort**

Standard shelves are required at the top and bottom of the unit. For use with Eclipse shelving only.

Available sizes:

Depths: 305, 355, 460 and 610mm

Lengths: 760, 915, 1070 and 1220mm

Create extra space with Eclipse Wall Shelving. Fully adjustable and strong.

